

## BROADBAND DUAL-RIDGE HORN ANTENNA

750 MHz TO 8 GHz

DRHA750

### KEY FEATURES

- Wide bandwidth and consistent directional radiation patterns
- Rugged and durable aluminum body
- VSWR typically below 2:1 with gain up to 12.5 dBi
- Professionally designed and hand-tested by engineers in the United States

### SPECIFICATIONS

- Design: Dual-Ridge Horn
- Operating Frequency: 750 MHz to 8 GHz
- Polarization: Linear (horizontal or vertical based on orientation)
- Connector: N Female
- Construction: Aluminum with PCB sides
- Mounting: 1/4-20 screw holes (see diagram on page 4)
- Length: 8.1 in [206 mm]
- Width: 10.0 in [255 mm]
- Height: 6.5 in [165 mm]
- Weight: 2.5 lbs [1.15 kg]



DRHA750

### PERFORMANCE DATA

Parameter	Frequency	Min.	Typ.	Max.	Unit	
VSWR	750 MHz – 1.0 GHz	1.1	2.0	3.5	—	
	1.0 GHz – 3.0 GHz	1.2	1.8	3.0		
	3.0 GHz – 8.0 GHz	1.05	1.4	2.6		
Gain	750 MHz – 1.0 GHz	3.0	5.0	7.5	dBi	
	1.0 GHz – 3.0 GHz	6.5	9.0	12.0		
	3.0 GHz – 8.0 GHz	9.5	11.0	13.0		
HPBW	750 MHz – 8 GHz	E-Plane	36	50	128	deg.
		H-Plane	18	45	80	
Input Power	750 MHz – 8 GHz	—	—	50	W	
Impedance	—	50			$\Omega$	
Connector	—	N (female)			—	

# BROADBAND DUAL-RIDGE HORN ANTENNA

750 MHz TO 8 GHz

DRHA750

## PERFORMANCE DATA (CONT.)

DRHA750 Voltage Standing Wave Ratio

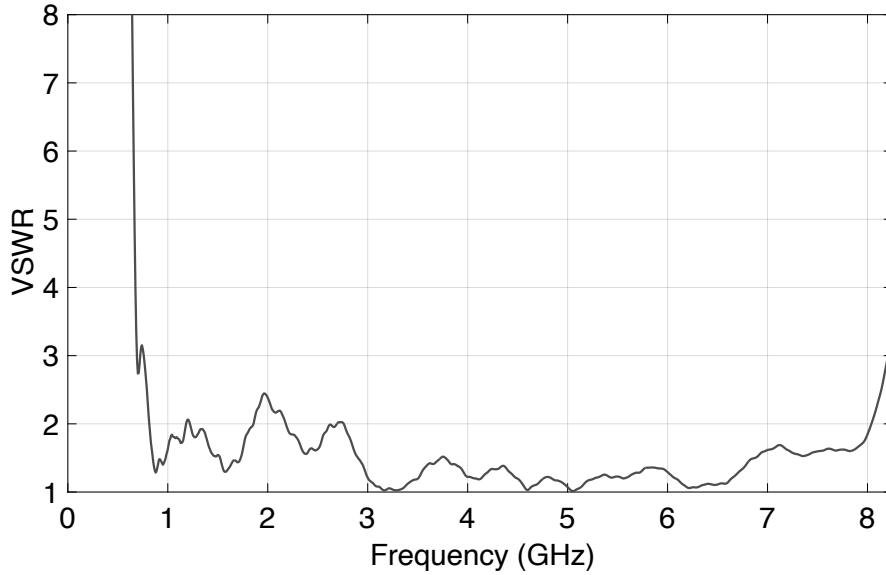

DRHA750 Gain

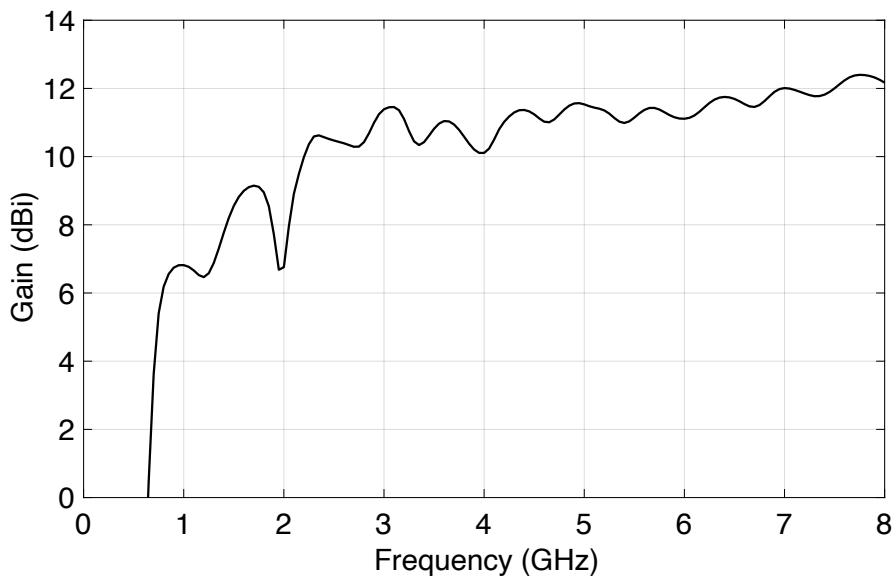

**BROADBAND DUAL-RIDGE HORN ANTENNA**

750 MHz TO 8 GHz

DRHA750

**PERFORMANCE DATA (CONT.)**

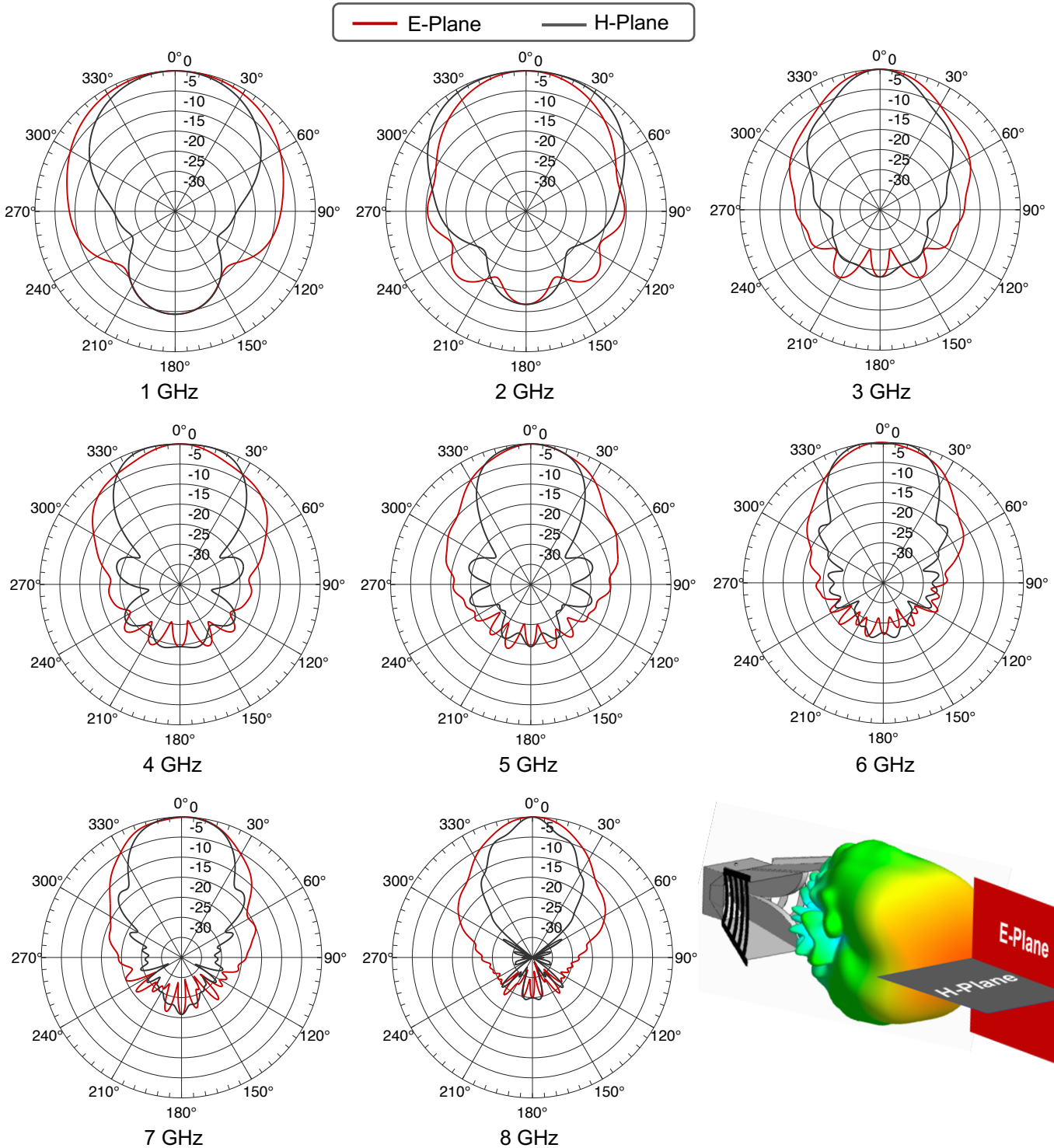

# BROADBAND DUAL-RIDGE HORN ANTENNA

750 MHz TO 8 GHz

DRHA750

## CAD DRAWING

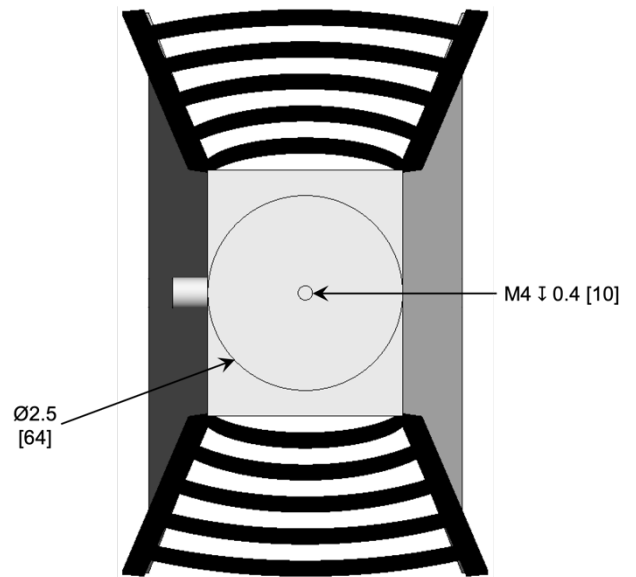
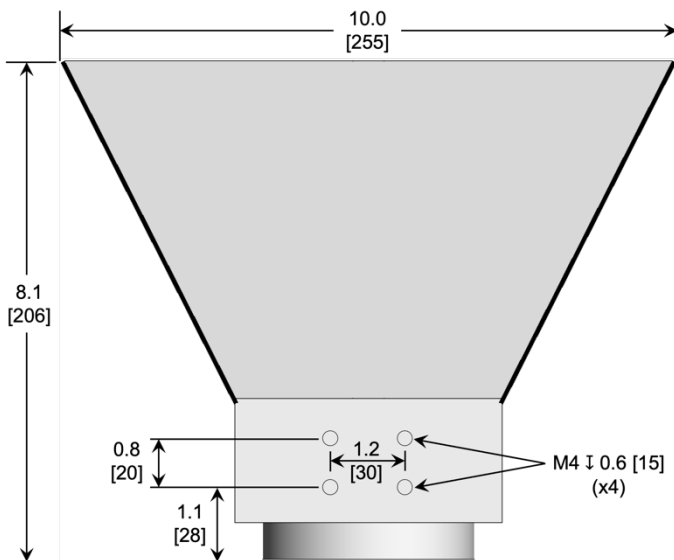
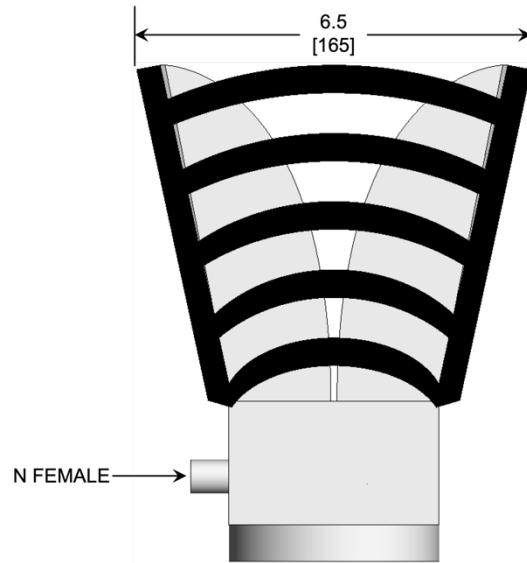
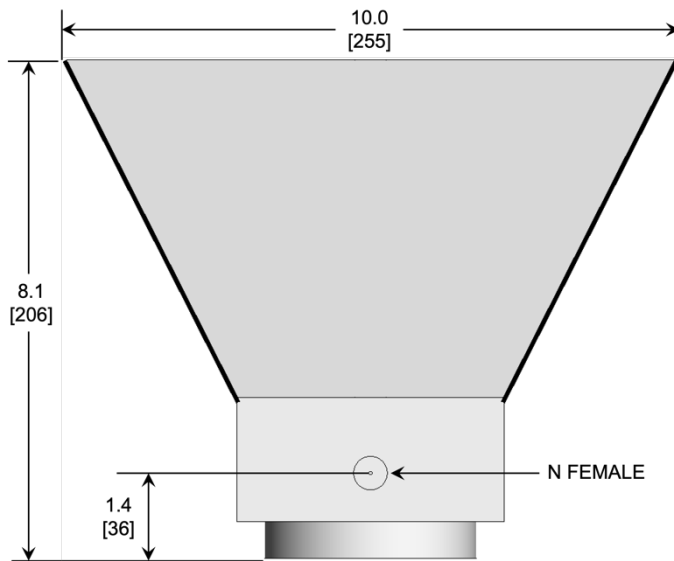

### NOTES

1. UNLESS OTHERWISE SPECIFIED ALL DIMENSIONS ARE NOMINAL
2. DIMENSIONS ARE IN INCHES [mm]
3. ALL SPECIFICATIONS ARE SUBJECT TO CHANGE WITHOUT NOTICE AT ANY TIME